



Cover Terminal

Space-saving, flexible, high protection class, use of copper- and aluminium-wiring

Product info

Cover Terminal

- the housing with the snap into place system can be opened and closed
- available in grey, blue, green
- maximum operating current 160A
- Protection class: IP23/IP33 with mounted cable

Technical data

maximum operating voltage	690V AC 1000V DC
maximum operating current	160A (Copper) 125A (Aluminium)
maximum torque	Ø11: 6-8 Nm on 6 - 50mm ² (input) Ø4,4: 2 Nm on 1,5 - 10mm ² (output)
material	Aluminium, tin plated

KA502

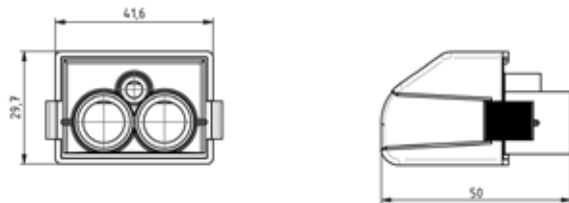

KA503

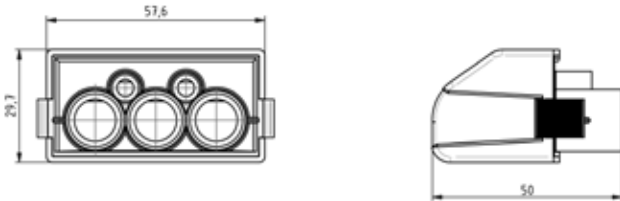

KA504

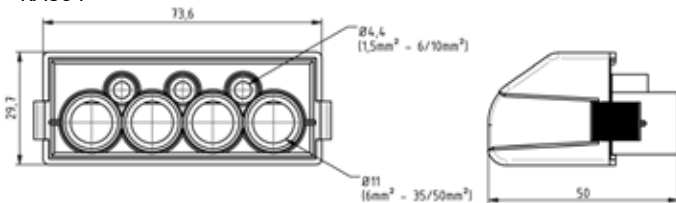

KA503



KA503N



KA503PE

KA503 | KA503N | KA503PE

with end sleeve:	3 x 6 - 35mm ² 2 x 1,5 - 6mm ²
fine or multi wire:	3 x 6 - 50mm ² 2 x 1,5 - 10mm ²
Dimensions:	57,6 x 29,7 x 50mm

KA503	690V AC, 1000V DC 160A (Cu) 125A (AL)
KA503N	690V AC, 1000V DC 160A (Cu) 125A (AL)
KA503PE	690V AC, 1000V DC 160A (Cu) 125A (AL)

Cross sections				
2 x 11 mm (KA502)	max.	50 mm ²	35 mm ²	
3 x 11 mm (KA503)	min.	6 mm ²	6 mm ²	
4 x 11 mm (KA504)				
1 x 4,4 mm (KA502)	max.	10 mm ²	6 mm ²	
2 x 4,4 mm (KA503)	min.	1,5 mm ²	1,5 mm ²	
3 x 4,4 mm (KA504)				

Application area: Lamp post, external distributor

* with end sleeve



KA502



KA502N



KA502PE

KA502 | KA502N | KA502PE

with end sleeve:	2 x 6 - 35mm ² 1 x 1,5 - 6mm ²
fine or multi wire:	2 x 6 - 50mm ² 1 x 1,5 - 10mm ²
Dimensions:	41,6 x 29,7 x 50mm

KA502	690V AC, 1000V DC 160A (Cu) 125A (AL)
KA502N	690V AC, 1000V DC 160A (Cu) 125A (AL)
KA502PE	690V AC, 1000V DC 160A (Cu) 125A (AL)



KA504



KA504N



KA504PE

KA504 | KA504N | KA504PE

with end sleeve:	4 x 6 - 35mm ² 3 x 1,5 - 6mm ²
fine or multi wire:	4 x 6 - 50mm ² 3 x 1,5 - 10mm ²
Dimensions:	73,6 x 29,7 x 50mm

KA504	690V AC, 1000V DC 160A (Cu) 125A (AL)
KA504N	690V AC, 1000V DC 160A (Cu) 125A (AL)
KA504PE	690V AC, 1000V DC 160A (Cu) 125A (AL)