

Cable trays in GRP
K² series - pressed



Challenging time



Composites FRP/GRP

A material whose features challenge time.

Five reasons to choose composites :

- 1 Resistance to corrosion
- 2 Insulating
- 3 Extremely robust and light
- 4 Long life span
- 5 Excellent fire characteristics



*Pultruded cable trays
KP series*



Pressed cable trays

*Supporting material
FX and FP series*



*Pultruded cable ladders
UL series*

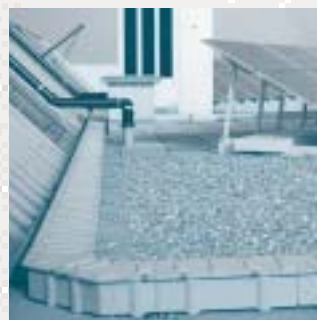

*Cable ducting system
BK series*

Ebo Systems :
40 years of experience
in the manufacture of
composite materials.

To **reduce** your installation time by **up to 50%** with :

- a system without interlocking screws and with self-adjustable couplings,
- 188 fittings to allow all configurations,
- a complete system, available from stock.

To **increase** the life span of your installation* using glass reinforced polyester (GRP) technology.



Summary

Advantages of GRP cable trays K² series	4
The K² series : cable trays and fittings in GRP	6
The K² series : multiple applications	9
How to choose your cable trays K² series	10
Technical features of the K² series	12
Method of installation : cable trays	18
Method of installation : fittings	19

Reference guide

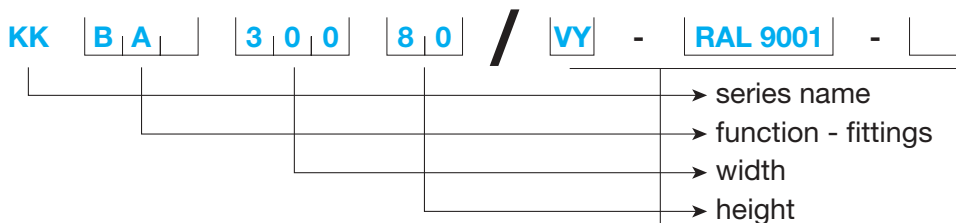

options : - resin : acrylic (AC), vinylester (VY), special (SP)
 - RAL color
 - ...

(*) This gain in life span is variable according to applications ; the gain is much more marked when comparing a GRP installation to galvanised steel in a very corrosive environment (eg : coastal sites, road tunnels...)

No corrosion



- Examples available of products in situ in aggressive environment for more than 40 years
- No electrolytic corrosion
- No need for painting and protective varnishes

The world's widest range



19 dimensions of cable trays available from stock
188 fittings available

Insulating



- Extremely insulating material (>7kV/m)
- No need to earth
- Excellent cable protection

Easy installation



- Interlocking and self-adjustable couplings
- No screws required

- No sharp edges
- No risk of injury



Maximum fire security



- Self-extinguishing, without toxic fumes
- Answers to the most demanding international fire norms
- Zero halogen
- Low thermal conductivity
- Allows cables to keep their electric function longer

Tailor-made solutions



- Light and robust
- Optimal transportation and handling



To complement the possibilities of the K² system

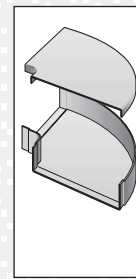
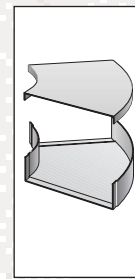
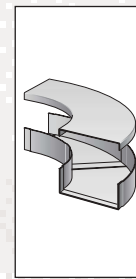
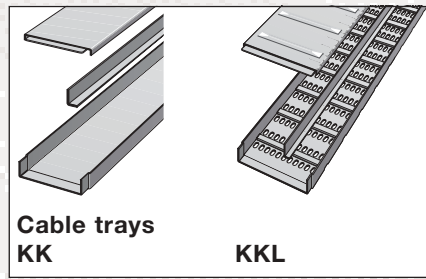

Height (mm)	Width (mm)		non perforated	perforated	separation	horizontal elbow 90° (large rad)	horizontal elbow 45° (large rad)	horizontal elbow 90° (small rad)				
50	50	cable tray	KK 5050	KKL 5050	standard KK T50	KK B10050	KK C10050	KK W5050				
		cover	KK D50					KK WD50				
	100	cable tray	KK 10050	KKL 10050				ready mounted KK T50/M	KK BD100	KK CD100	KK W10050	
		cover	KK D100						KK WD100			
	150	cable tray	KK 15050	KKL 15050				KK BD150	KK CD150	KK W15050		
		cover	KK D150					KK WD150				
	200	cable tray	KK 20050	KKL 20050				KK B20050	KK C20050	KK W20050		
		cover	KK D200					KK WD200				
	300	cable tray	KK 30050	KKL 30050				KK B30050	KK C30050	KK W30050		
		cover	KK D300					KK BD300	KK CD300	KK WD300		
	80	100	cable tray	KK 10080				KKL 10080	standard KK T80	KK B10080	KK C10080	KK W10080
			cover	KK D100				KK BD100		KK CD100	KK WD100	
150		cable tray	KK 15080	KKL 15080	KK B15080	KK C15080	KK W15080					
		cover	KK D150		KK BD150	KK CD150	KK WD150					
200		cable tray	KK 20080	KKL 20080	KK B20080	KK C20080	KK W20080					
		cover	KK D200		KK BD200	KK CD200	KK WD200					
250		cable tray	KK 25080	KKL 25080	KK B25080	KK C25080	KK W25080					
		cover	KK D250		KK BD250	KK CD250	KK WD250					
300		cable tray	KK 30080	KKL 30080	ready mounted KK T80/M	KK B30080	KK C30080	KK W30080				
		cover	KK D300			KK BD300	KK CD300	KK WD300				
400		cable tray	KK 40080	KKL 40080	KK B40080	KK C40080	KK W40080					
		cover	KK D400		KK BD400	KK CD400	KK WD400					
500	cable tray	KK 50080	KKL 50080	KK B50080	KK C50080	KK W50080						
	cover	KK D500		KK BD500	KK CD500	KK WD500						
600	cable tray	KK 60080	KKL 60080	KK B60080	KK C60080	KK W60080						
	cover	KK D600		KK BD600	KK CD600	KK WD600						
110	100	cable tray	KK 100110	KKL 100110	standard KK T110	KK B100110	KK C100110	KK W100110				
		cover	KK D100			KK BD100	KK CD100	KK WD100				
	200	cable tray	KK 200110	KKL 200110		KK B200110	KK C200110	KK W200110				
		cover	KK D200			KK BD200	KK CD200	KK WD200				
	300	cable tray	KK 300110	KKL 300110		KK B300110	KK C300110	KK W300110				
		cover	KK D300			KK BD300	KK CD300	KK WD300				
	400	cable tray	KK 400110	KKL 400110		ready mounted KK T110/M	KK B400110	KK C400110	KK W400110			
		cover	KK D400				KK BD400	KK CD400	KK WD400			
	500	cable tray	KK 500110	KKL 500110		KK B500110	KK C500110	KK W500110				
		cover	KK D500			KK BD500	KK CD500	KK WD500				
	600	cable tray	KK 600110	KKL 600110		KK B600110	KK C600110	KK W600110				
		cover	KK D600			KK BD600	KK CD600	KK WD600				
unit			3 m		piece	piece	piece					

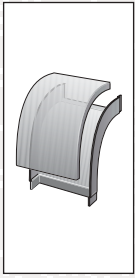

Exterior elbow 90°

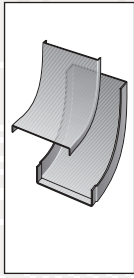

Interior elbow 90°

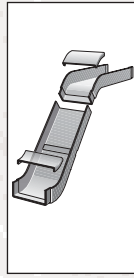

Changing elevation 45°

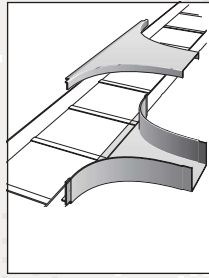

T-Junction (large rad)

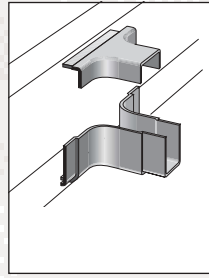

T-Junction (small rad)

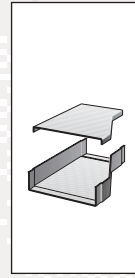

Left hand reduction

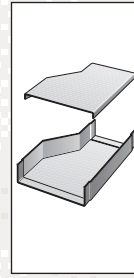

Right hand reduction

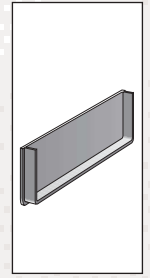

Endcap

KK BA5050
 KK BAD5050
 KK BA10050
 KK BAD10050
 KK BA15050
 KK BAD15050
 KK BA20050
 KK BAD20050
 KK BA30050
 KK BAD30050

KK BI5050
 KK BID5050
 KK BI10050
 KK BID10050
 KK BI15050
 KK BID15050
 KK BI20050
 KK BID20050
 KK BI30050
 KK BID30050

KK ET10050
 KK ETD10050
 KK ET15050
 KK ETD15050
 KK ET20050
 KK ETD20050
 KK ET30050
 KK ETD30050

KK ST10050
 KK STD100
 KK ST15050
 KK STD150
 KK ST20050
 KK STD200
 KK ST30050
 KK STD300

KK SS5050
 KK SSD50
 KK SS10050
 KK SSD100
 KK SS15050
 KK SSD150
 KK SS20050
 KK SSD200
 KK SS30050
 KK SSD300

KK RL20050
 KK RLD200
 KK RL30050
 KK RLD300

KK RR20050
 KK RRD200
 KK RR30050
 KK RRD300

KK KE5050
 KK KE10050
 KK KE15050
 KK KE20050
 KK KE30050

KK BA10080
 KK BAD10080
 KK BA15080
 KK BAD15080
 KK BA20080
 KK BAD20080
 KK BA25080
 KK BAD25080
 KK BA30080
 KK BAD30080
 KK BA40080
 KK BAD40080
 KK BA50080
 KK BAD50080
 KK BA60080
 KK BAD60080

KK BI10080
 KK BID10080
 KK BI15080
 KK BID15080
 KK BI20080
 KK BID20080
 KK BI25080
 KK BID25080
 KK BI30080
 KK BID30080
 KK BI40080
 KK BID40080
 KK BI50080
 KK BID50080
 KK BI60080
 KK BID60080

KK ET10080
 KK ETD10080
 KK ET15080
 KK ETD15080
 KK ET20080
 KK ETD20080
 KK ET25080
 KK ETD25080
 KK ET30080
 KK ETD30080
 KK ET40080
 KK ETD40080
 KK ET50080
 KK ETD50080
 KK ET60080
 KK ETD60080

KK ST10080
 KK STD100
 KK ST15080
 KK STD150
 KK ST20080
 KK STD200
 KK ST25080
 KK STD250
 KK ST30080
 KK STD300
 KK ST40080
 KK STD400
 KK ST50080
 KK STD500
 KK ST60080
 KK STD600

KK SS10080
 KK SSD100
 KK SS15080
 KK SSD150
 KK SS20080
 KK SSD200
 KK SS25080
 KK SSD250
 KK SS30080
 KK SSD300

KK RL20080
 KK RLD200
 KK RL30080
 KK RLD300
 KK RL40080
 KK RLD400
 KK RL50080
 KK RLD500
 KK RL60080
 KK RLD600

KK RR20080
 KK RRD200
 KK RR30080
 KK RRD300
 KK RR40080
 KK RRD400
 KK RR50080
 KK RRD500
 KK RR60080
 KK RRD600

KK KE10080
 KK KE15080
 KK KE20080
 KK KE25080
 KK KE30080
 KK KE40080
 KK KE50080
 KK KE60080

KK BA100110
 KK BAD100110
 KK BA200110
 KK BAD200110
 KK BA300110
 KK BAD300110
 KK BA400110
 KK BAD400110
 KK BA500110
 KK BAD500110
 KK BA600110
 KK BAD600110

KK BI100110
 KK BID100110
 KK BI200110
 KK BID200110
 KK BI300110
 KK BID300110
 KK BI400110
 KK BID400110
 KK BI500110
 KK BID500110
 KK BI600110
 KK BID600110

KK ET100110
 KK ETD100110
 KK ET200110
 KK ETD200110
 KK ET300110
 KK ETD300110
 KK ET400110
 KK ETD400110
 KK ET500110
 KK ETD500110
 KK ET600110
 KK ETD600110

KK ST100110
 KK STD100
 KK ST200110
 KK STD200
 KK ST300110
 KK STD300
 KK ST400110
 KK STD400
 KK ST500110
 KK STD500
 KK ST600110
 KK STD600

KK SS100110
 KK SSD100
 KK SS200110
 KK SSD200
 KK SS300110
 KK SSD300
 KK SS400110
 KK SSD400
 KK SS500110
 KK SSD500
 KK SS600110
 KK SSD600

KK RL200110
 KK RLD200
 KK RL300110
 KK RLD300
 KK RL400110
 KK RLD400
 KK RL500110
 KK RLD500
 KK RL600110
 KK RLD600

KK RR200110
 KK RRD200
 KK RR300110
 KK RRD300
 KK RR400110
 KK RRD400
 KK RR500110
 KK RRD500
 KK RR600110
 KK RRD600

KK KE100110
 KK KE200110
 KK KE300110
 KK KE400110
 KK KE500110
 KK KE600110

piece

piece

piece

piece

piece

piece

piece

piece

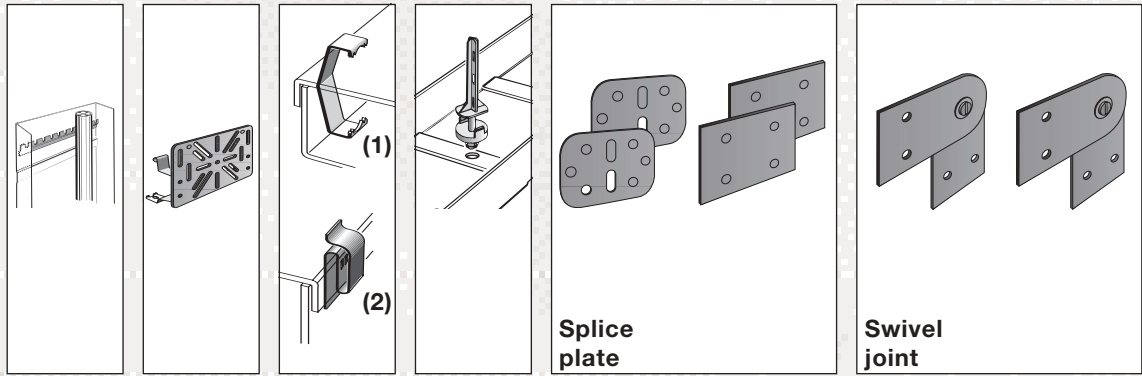

Height (mm)	Width (mm)	Cable rack for vertical mounting	Mounting plate	Cover clip	Separator stud	splice plate	polyester	stainless steel	polyester
50	50								
	100	KR100	MP 50	standard (1) DF 50 universal (2) DF 1060	TB	KK IH50	KK GH50	KK IV50	KK GV50
	150	KR150							
	200	KR200							
	300	KR300							
80	KR100	MP 80							
150	KR150								
200	KR200								
250	KR250								
300	KR300								
400	KR400								
500	KR500								
600	KR600								
110	200	KR200	MP 110	standard (1) DF 100 universal (2) DF 1060	TB	KK IH110	KK GH110	KK IV110	KK GV110
	300	KR300							
	400	KR400							
	500	KR500							
	600	KR600							
Unit		piece	piece	piece	piece	set	set	set	set

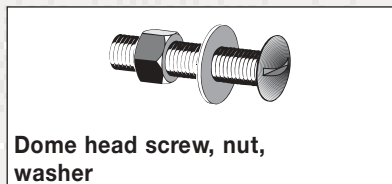

diameter (mm)	length (mm)	Dome head screw, nut, washer	
		V4A steel	Polyamide
6	16	M616/V4A-DOM	
	20	M620/V4A-DOM	
8	20		M820/PA6-DOM
10	30	M1030/V4A-DOM	*
Unit		100 pieces	

* : for polyamide screw, reference M1030/PA6, please consult us



Transport
trackside, road and railway
tunnels, bridges, stations,
boatyards...



Transformation industries
chemical and petrochemical,
agriculture and food indus-
tries, textile and paper indus-
tries...



Energy Distribution
water and recycling, power
stations, nuclear plants,
extraction and mining, gas...



Tertiary sector
public buildings, administrati-
ve, banks, telecommunica-
tion...

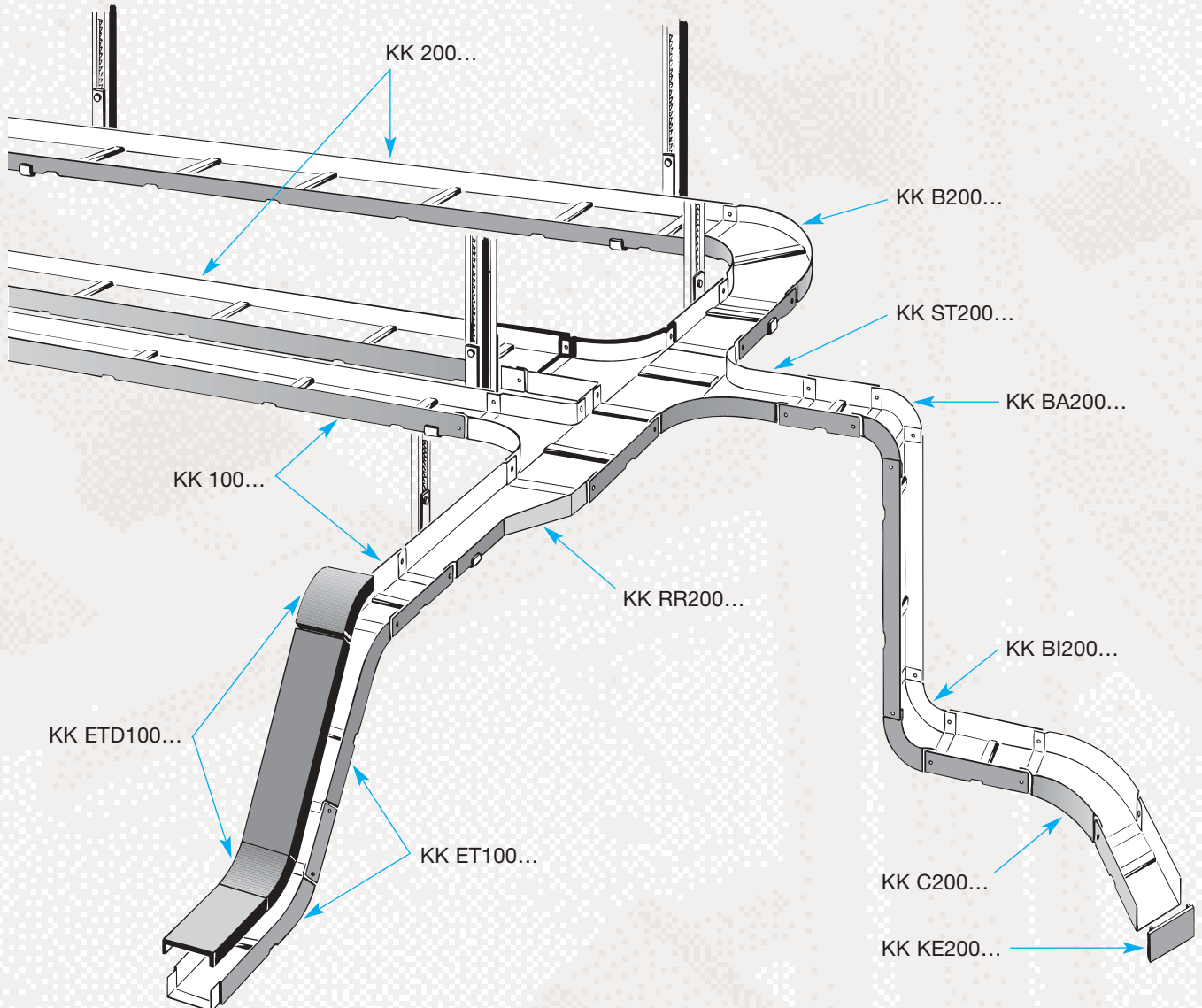

Choosing the best suited product for your application is an essential stage for the restraint of costs and the long-term benefit of your installation.

Ebo systems proposes a complete range that answers :

- your needs in term of cable capacity,
- the diversity of your installation in term of configuration and dimensions,
- your need for reliable and rapid installation time.

Cable trays *K² series* : the best choice for your industrial applications

The *K²* range has especially been designed to offer :

- **maximum mechanical resistance** : deflection ⁽¹⁾ < 5 mm (1/300) taking into consideration the reference and the level of fill ⁽²⁾.
- **a fast and sure installation** : new system of interlocking and self adjustable couplings, without bolts.
- **a guarantee of security** : Ebo System cable trays have a built in coefficient of safety > 1,7 (in accordance with the international norm IEC 61537).



cable trays with expansion joint

(1) In certain cases it may be necessary to use supporting distances > 1,5 metres. It may be possible, using certain precautions,

to use the *K² series*, (please consult Ebo Systems for specific information) or the *KP* or *UL* series for optimum results.

(2) Cable trays are designed to support loads bound solely to the weight of cables.

Recommended rate of replenishment

In order to anticipate future needs of your installation, and to ensure cables function correctly, Ebo Systems recommends a **maximum fill of 50%**.



Test conditions

All our cable trays are tested below according to the diagram at an ambient temperature of 25°C.

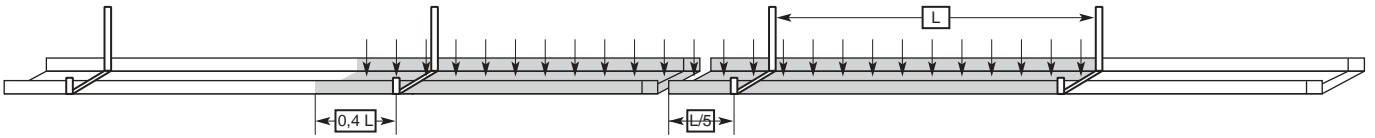

L = supporting distance

Diagram of loads K² series : supporting distance = 1,5 metres
(for greater span, refer to Ebo Systems)

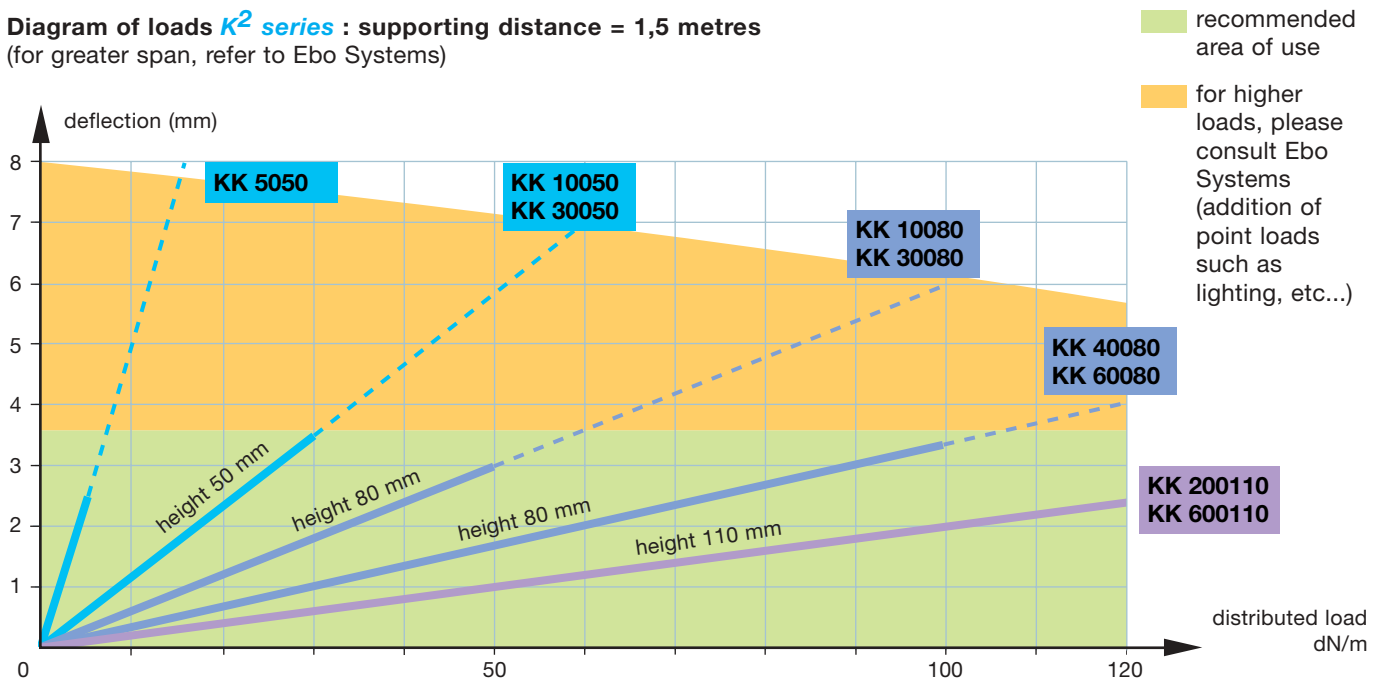

Guide choice : 19 dimensions of cable trays available from stock

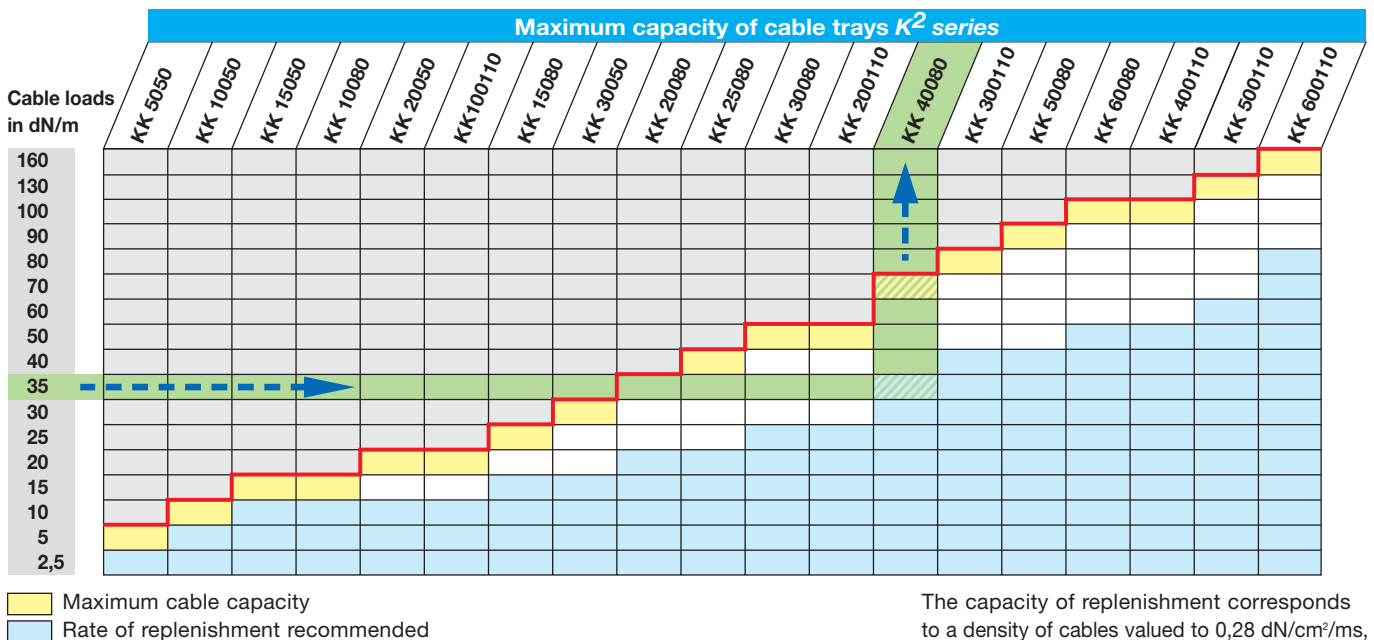

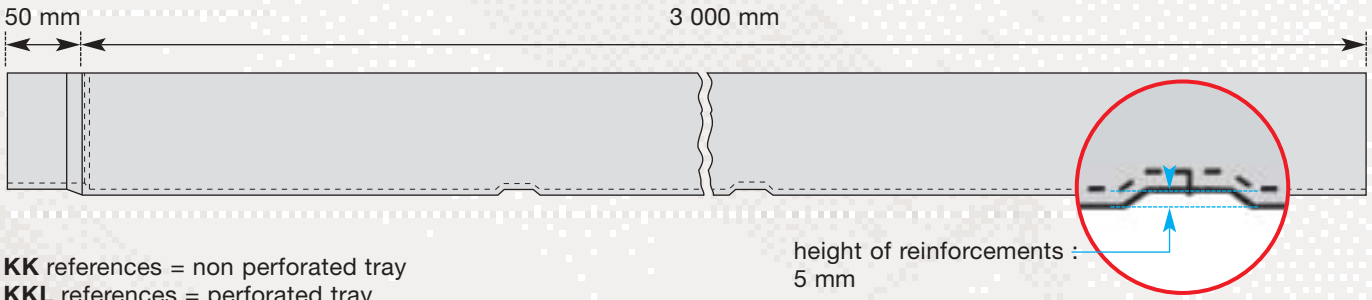
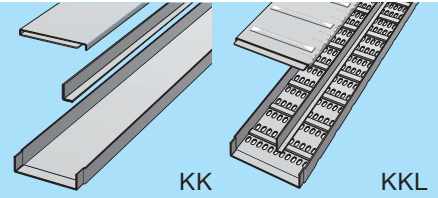

KK references = non perforated tray
KKL references = perforated tray

Height (mm)	Width (mm)	Thickness (mm)	Reference	Weight (kg/m)		Section (mm ²)	Reinforcements
				tray	tray +cover		
50	50	3	KK(L) 5050	0,7	1,2	1 500	No
	100	3	KK(L) 10050	1,0	1,8	3 700	
	150	3	KK(L) 15050	1,2	2,3	5 900	
	200	3	KK(L) 20050	1,5	2,9	8 100	
	300	3	KK(L) 30050	2,1	4,0	12 500	
80	100	3	KK(L) 10080	1,3	2,1	6 500	Yes
	150	3	KK(L) 15080	1,7	2,7	10 200	
	200	3	KK(L) 20080	2,0	3,3	13 900	
	250	3	KK(L) 25080	2,2	3,7	17 600	
	300	3	KK(L) 30080	2,5	4,4	21 300	
	400	4	KK(L) 40080	3,9	6,3	27 600	
	500	4	KK(L) 50080	4,8	8,0	34 800	
110	100	4	KK(L) 100110	2,2	3,0	8 500	Yes
	200	4	KK(L) 200110	2,8	4,1	18 800	
	300	4	KK(L) 300110	3,7	5,6	29 100	
	400	4	KK(L) 400110	4,3	6,7	39 400	
	500	4	KK(L) 500110	5,0	8,2	49 700	
	600	4	KK(L) 600110	5,7	9,1	60 000	

Ratings of perforated cable trays KKL :

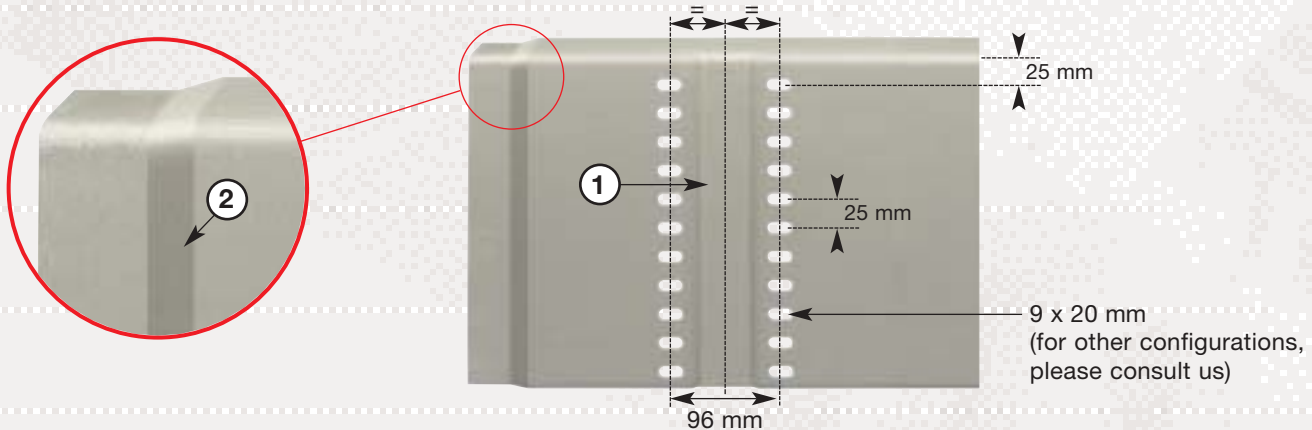

① The transverse reinforcements of the *K²* series are accepted for all applications by the installation guide UTE C15-900, including cables to very high debit (application class D, frequency 16 MHz).

②

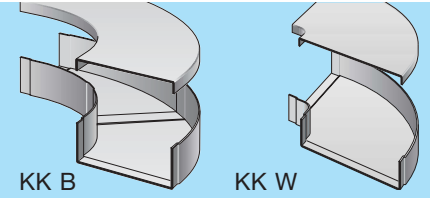

Large rad

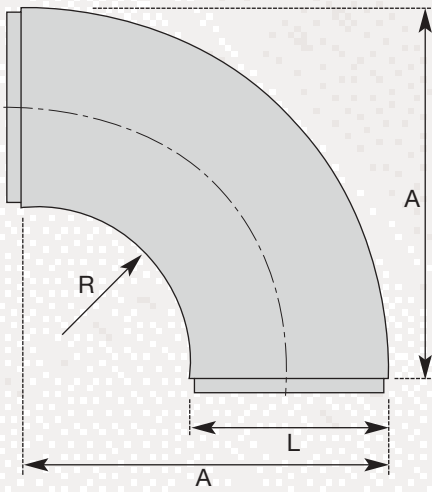

Height (mm)	Width L (mm)	Reference	Weight (kg)		Rad R (mm)	Dimension A (mm)
			tray	tray + cover		
50	50					
	100	KK B10050	0,3	0,5	100	225
	150	KK B15050	0,6	1,0	175	350
	200	KK B20050	0,8	1,5	200	425
	300	KK B30050	1,3	2,3	225	550
80	100	KK B10080	0,4	0,6	100	225
	150	KK B15080	0,7	1,2	175	350
	200	KK B20080	0,9	1,6	200	425
	250	KK B25080	1,3	2,3	275	550
	300	KK B30080	1,5	2,5	225	550
	400	KK B40080	3,2	5,9	250	725
	500	KK B50080	4,5	8,5	250	825
110	100	KK B100110	0,8	1,0	100	225
	200	KK B200110	1,3	2,0	200	425
	300	KK B300110	1,9	2,9	225	550
	400	KK B400110	3,6	6,3	250	725
	500	KK B500110	4,9	8,9	250	825
	600	KK B600110	5,8	10,6	250	925

Small rad

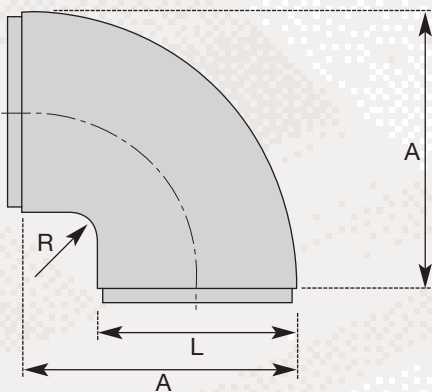

Height (mm)	Width L (mm)	Reference	Weight (kg)		Rad R (mm)	Dimension A (mm)
			tray	tray + cover		
50	50	KK W5050	0,1	0,2	25	100
	100	KK W10050	0,2	0,3	25	150
	150	KK W15050	0,3	0,5	25	200
	200	KK W20050	0,4	0,8	25	250
	300	KK W30050	0,6	1,2	25	350
80	100	KK W10080	0,2	0,4	25	150
	150	KK W15080	0,3	0,6	25	200
	200	KK W20080	0,5	0,7	25	250
	250	KK W25080	0,6	1,0	25	300
	300	KK W30080	0,8	1,4	25	350
	400	KK W40080	1,2	2,2	25	450
	500	KK W50080	2,0	3,3	25	550
100	100	KK W100110	0,4	0,6	25	150
	200	KK W200110	0,7	0,9	25	250
	300	KK W300110	1,0	1,6	25	350
	400	KK W400110	1,4	2,4	25	450
	500	KK W500110	2,2	3,5	25	550
	600	KK W600110	2,6	4,5	25	650

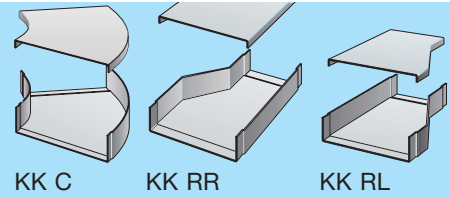

Elbow 45°

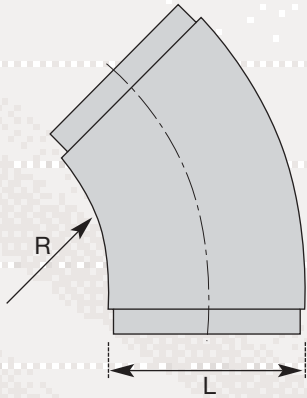

Height (mm)	Width L (mm)	Reference	Weight (kg)		Rad R (mm)
			tray	tray + cover	
50	100	KK C10050	0,1	0,2	100
	150	KK C15050	0,2	0,4	175
	200	KK C20050	0,3	0,6	200
	300	KK C30050	0,6	1,1	225
80	100	KK C10080	0,2	0,3	100
	150	KK C15080	0,4	0,6	175
	200	KK C20080	0,5	0,8	200
	250	KK C25080	0,6	1,1	275
	300	KK C30080	0,8	1,3	225
	400	KK C40080	2,5	4,5	250
	500	KK C50080	2,8	4,9	250
	600	KK C60080	3,0	5,3	250
110	100	KK C100110	0,4	0,5	200
	200	KK C200110	0,7	1,0	200
	300	KK C300110	1,0	1,5	225
	400	KK C400110	2,5	4,5	250
	500	KK C500110	3,0	5,1	250
	600	KK C600110	3,2	5,5	250

Left hand reduction
Right hand reduction

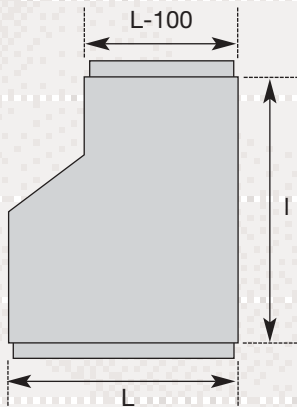

Height (mm)	Width L (mm)	Reference*	Weight (kg)		I (mm)
			tray	tray + cover	
50	200	KK ..20050	0,5	1,0	500
	300	KK ..30050	1,0	1,4	500
80	200	KK ..20080	0,9	1,4	500
	300	KK ..30080	1,2	2,0	500
	400	KK ..40080	1,6	2,7	500
	500	KK ..50080	1,9	3,3	500
	600	KK ..60080	2,2	3,8	500
110	200	KK ..200110	1,3	1,8	500
	300	KK ..300110	1,6	2,4	500
	400	KK ..400110	2,0	3,1	500
	500	KK ..500110	2,3	3,7	500
	600	KK ..600110	2,6	4,2	500

*.. : RR = reducer right hand,
RL = reducer left hand

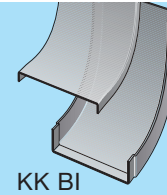

KK BI

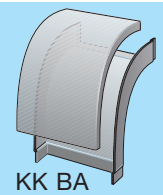

KK BA

Interior elbow 90°

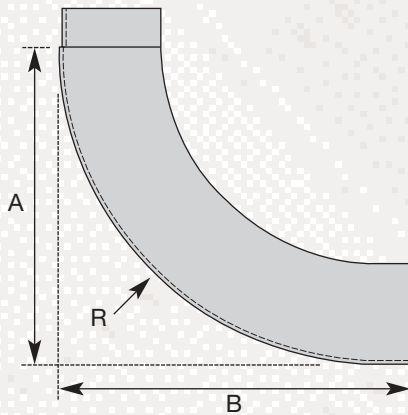

Height (mm)	Width (mm)	Reference	Weight (kg)		Rad R (mm)	Dimension (mm)	
			tray	tray + cover		A	B
50	50	KK BI5050	0,1	0,2	75	100	100
	100	KK BI10050	0,4	0,6	250	250	280
	150	KK BI15050	0,5	0,7	250	250	280
	200	KK BI20050	0,6	1,0	250	250	280
	300	KK BI30050	0,9	1,4	250	250	280
80	100	KK BI10080	0,5	0,7	250	250	280
	150	KK BI15080	0,6	0,9	250	250	280
	200	KK BI20080	0,8	1,1	250	250	280
	250	KK BI25080	1,0	1,3	250	250	280
	300	KK BI30080	1,0	1,5	250	250	280
	400	KK BI40080	1,2	1,8	250	250	280
	500	KK BI50080	1,5	2,2	250	250	280
600	KK BI60080	1,7	2,6	250	250	280	
110	100	KK BI100110	0,7	0,9	250	250	280
	200	KK BI200110	1,0	1,3	250	250	280
	300	KK BI300110	1,2	1,7	250	250	280
	400	KK BI400110	1,4	2,0	250	250	280
	500	KK BI500110	1,7	2,4	250	250	280
	600	KK BI600110	1,9	2,8	250	250	280

Elbow 90° exterior

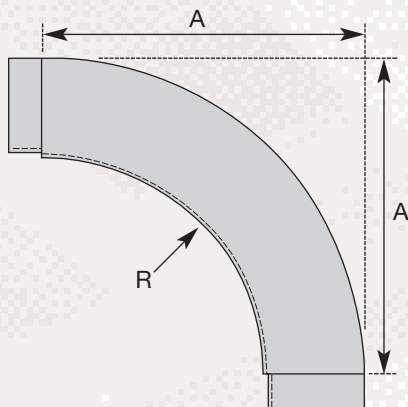

Height (mm)	Width (mm)	Reference	Weight (kg)		Rad R (mm)	Dimension A (mm)
			tray	tray + cover		
50	50	KK BA5050	0,1	0,2	25	100
	100	KK BA10050	0,3	0,6	170	245
	150	KK BA15050	0,4	0,8	170	245
	200	KK BA20050	0,5	1,0	170	245
	300	KK BA30050	0,7	1,3	170	245
80	100	KK BA10080	0,4	0,7	170	275
	150	KK BA15080	0,5	1,0	170	275
	200	KK BA20080	0,6	1,1	170	275
	250	KK BA25080	0,7	1,3	170	275
	300	KK BA30080	0,8	1,5	170	275
	400	KK BA40080	1,0	1,9	170	275
	500	KK BA50080	1,1	2,3	170	275
600	KK BA60080	1,4	2,7	170	275	
110	100	KK BA100110	0,7	1,0	170	345
	200	KK BA200110	0,9	1,4	170	345
	300	KK BA300110	1,1	1,8	170	345
	400	KK BA400110	1,3	2,2	170	345
	500	KK BA500110	1,4	2,6	170	345
	600	KK BA600110	1,7	3,0	170	345

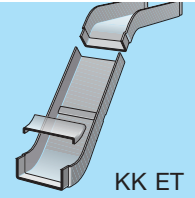

KK ET

Height (mm)	Width (mm)	Reference A+B	Weight (kg)		Dimension (mm)			Rad (mm)	
			tray	tray + cover	H1	H2	H mini	R1	R2
80	100	KK ET10080	1,9	2,1	800	480	160	170	250
	150	KK ET15080	2,4	2,8	800	480	160	170	250
	200	KK ET20080	2,7	3,1	800	480	160	170	250
	250	KK ET25080	3,1	3,6	800	480	160	170	250
	300	KK ET30080	3,5	4,1	800	480	160	170	250
	400	KK ET40080	4,2	5,0	800	480	160	170	250
	500	KK ET50080	5,0	6,0	800	480 <td 160	170	250	
	600	KK ET60080	6,0	7,1	800	480	160	170	250

Set changing elevation :

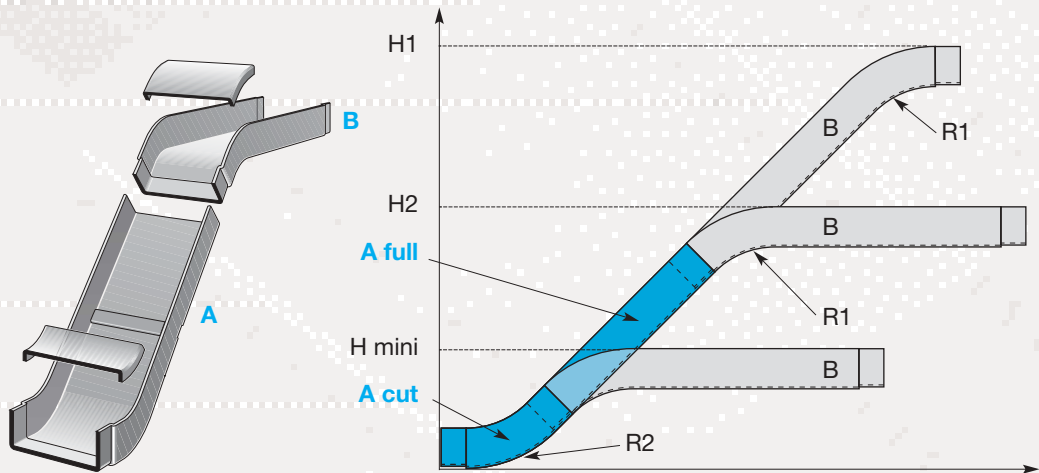

Splice plates (specifically for angled connections)
Stainless steel

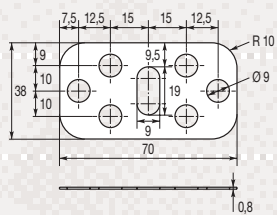

KK IH50

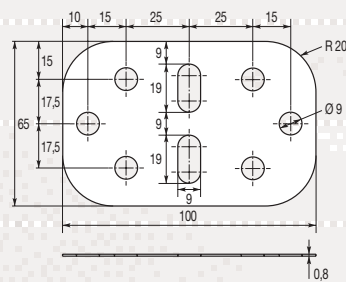

KK IH80

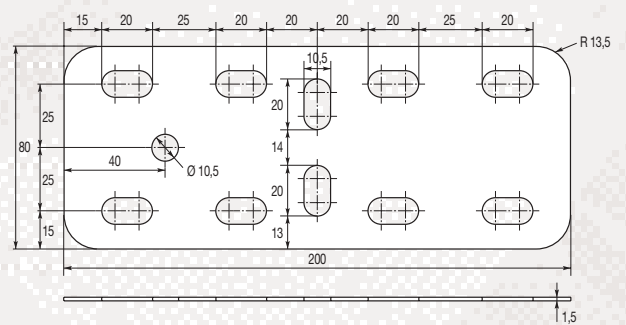

KK IH110

Polyester

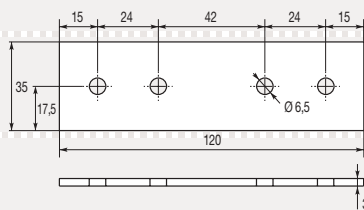

KK GH50

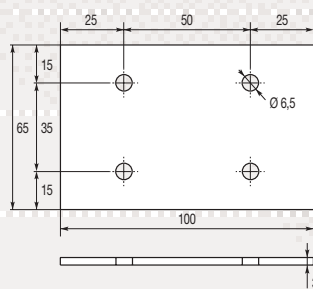

KK GH80

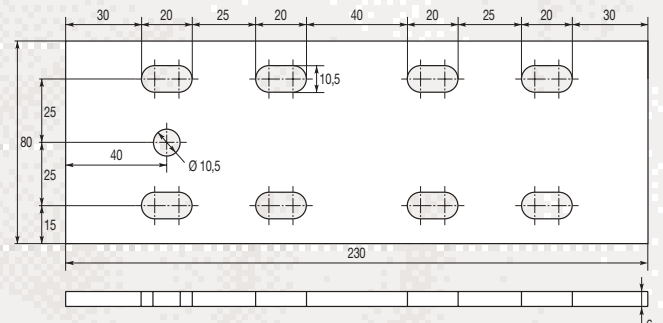

KK GH110

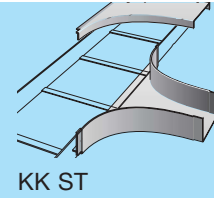

KK ST

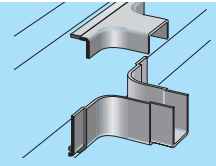

KK SS

Large rad

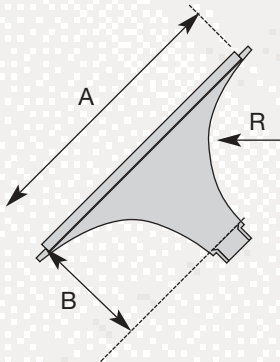

Height (mm)	Width (mm)	Reference	Weight (kg)		Rad R (mm)	Dimension (mm)	
			tray	tray + cover		A	B
50	50						
	100	KK ST10050	0,6	1,0	250	600	250
	150	KK ST15050	0,7	1,2	250	650	250
	200	KK ST20050	0,8	1,3	250	700	250
	300	KK ST30050	1,0	1,7	250	800	250
80	100	KK ST10080	0,7	1,1	250	600	250
	150	KK ST15080	0,8	1,3	250	650	250
	200	KK ST20080	0,9	1,5	250	700	250
	250	KK ST25080	1,0	1,7	250	750	250
	300	KK ST30080	1,1	1,8	250	800	250
	400	KK ST40080	1,2	2,0	250	900	250
	500	KK ST50080	1,4	2,4	250	1000	250
600	KK ST60080	1,6	2,7	250	1100	250	
110	100	KK ST100110	1,0	1,4	250	700	250
	200	KK ST200110	1,2	1,8	250	700	250
	300	KK ST300110	1,4	2,1	250	800	250
	400	KK ST400110	1,5	2,3	250	900	250
	500	KK ST500110	1,7	2,7	250	1000	250
	600	KK ST600110	1,9	3,0	250	1100	250

Small rad

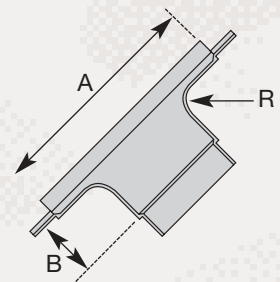

Height (mm)	Width (mm)	Reference	Weight (kg)		Rad R (mm)	Dimension (mm)	
			tray	tray + cover		A	B
50	50	KK SS5050	0,1	0,1	25	150	50
	100	KK SS10050	0,1	0,2	25	200	50
	150	KK SS15050	0,2	0,3	25	250	50
	200	KK SS20050	0,2	0,3	25	300	50
	300	KK SS30050	0,3	0,5	25	400	50
80	100	KK SS10080	0,1	0,2	25	200	50
	150	KK SS15080	0,2	0,3	25	250	50
	200	KK SS20080	0,2	0,3	25	300	50
	250	KK SS25080	0,3	0,4	25	350	50
	300	KK SS30080	0,3	0,5	25	400	50
	400						
	500						
600							

For fast and secure installation

1. Support the cable tray at a distance of around 30 cm from one end

$$30 \text{ cm} = L/5$$

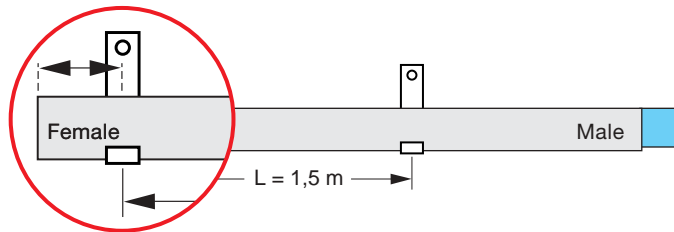

The joint between two trays should ideally be located at a distance of approximately L/5 : this ensures the optimum strength of the joint.

2. To position couplings without screwing junctions

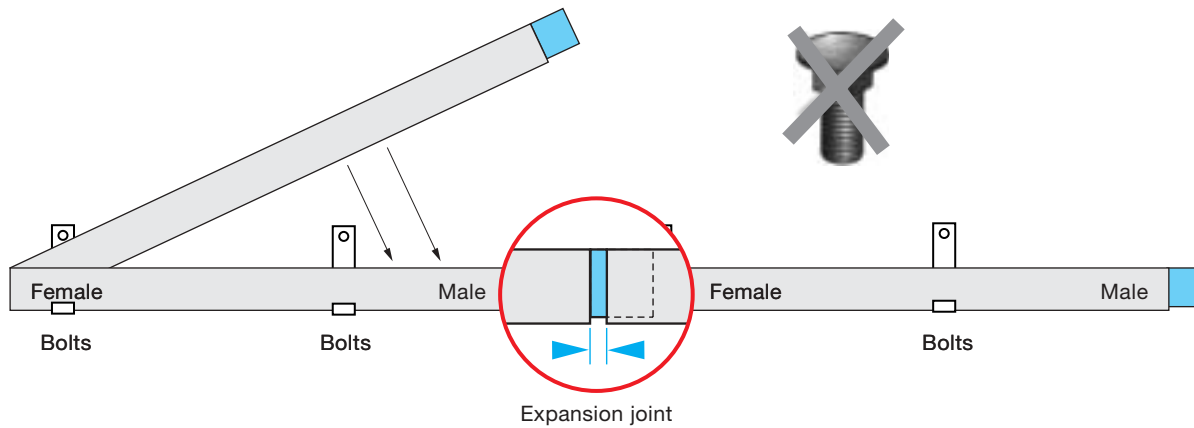

Thanks to the in built butt, the 2 lengths of cable tray position themselves automatically in an optimal way in order to give an expansion joint of 8 mm.

3. To fix the cover with clips made of steel 316 (references : DF 50, DF 80, DF 100)

in normal conditions (interior, weak winds) : use one clip per metre on alternate sides of the tray

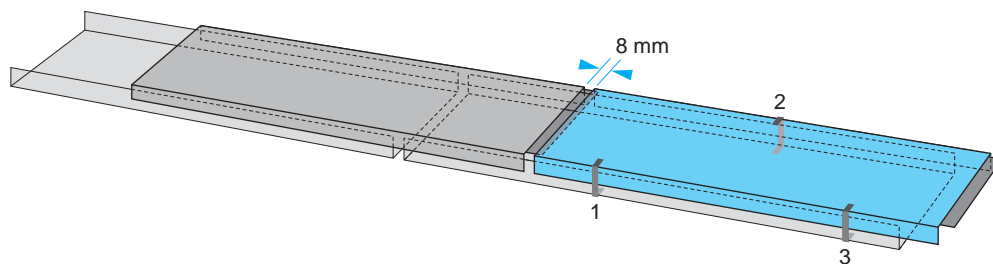

in extreme conditions (strong winds, > 60 km/h) : use 4 clips per 3 metre length of cable tray. Clips can be replaced by banding.

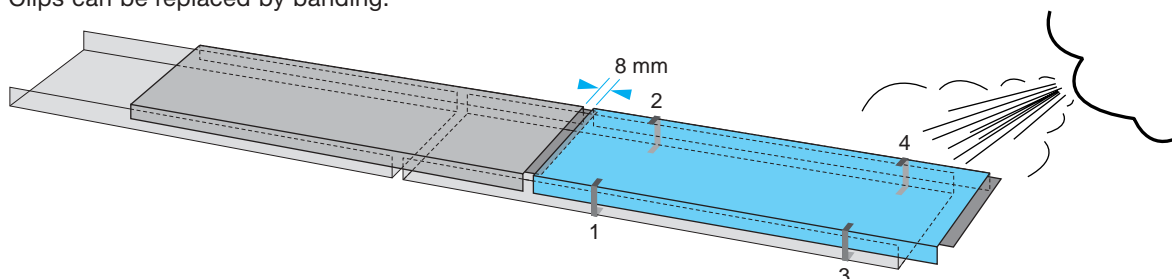

To ensure maximum strength, the joint of the cover and the tray should not lie one above the other.

Installation examples

- All fittings must be fixed laterally by **1 screw on each side**.
- Every junction should have an **accompanying support** within 20 cm.
- Fittings of large dimensions require a **central support**.

Changing elevation

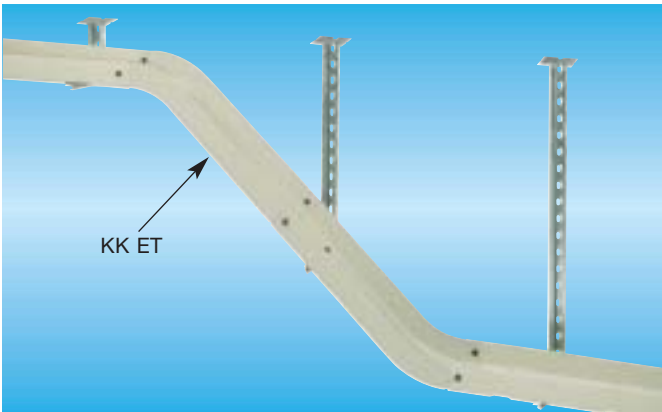

With fitting

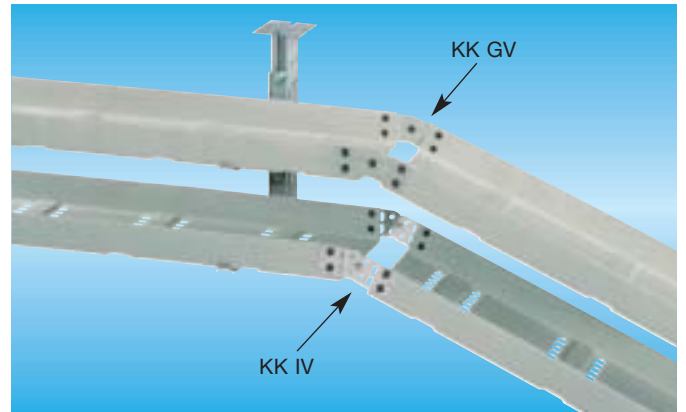

Installation on site with splice plate

Change of direction

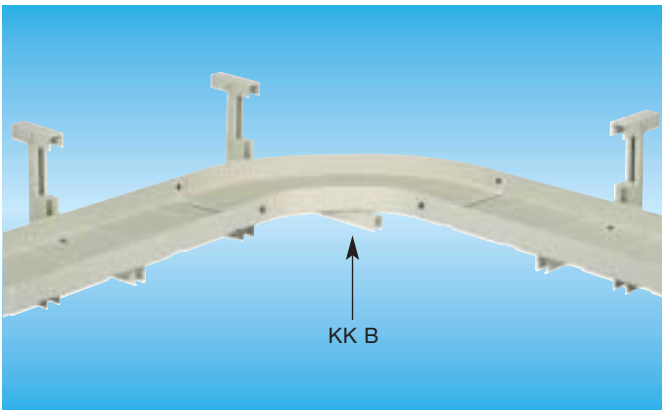

With fitting

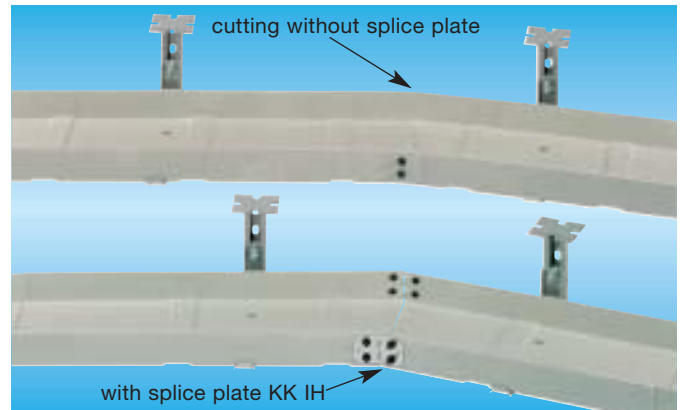

Installation on site with/without splice plate

T - junction

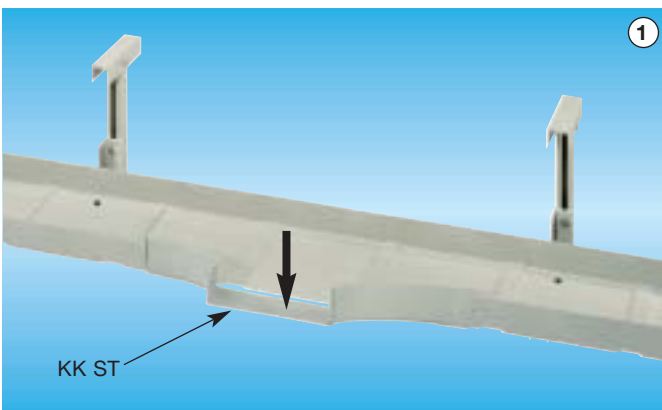

With fitting





do not hesitate to complete
your catalogue with



Corporate brochure and CD-Rom



Technical catalogs



Market application sheets



Resin characteristics



Head office

Ebo Systems
Boulevard d'Europe
B.P. 10
F - 67211 Obernai Cedex
Tel. +33 (0)3 88 49 50 51
Fax. +33 (0)3 88 49 50 14
e-mail : info@ebo-systems.com

Production

Ebo Systems S.A.S.
Zone industrielle
B.P. 5
F - 54920 Villers-la-Montagne
Tel. +33 (0)3 82 44 01 07
Fax. +33 (0)3 82 26 10 41
e-mail : info.prod@ebo-systems.com

Market areas

**Belgium, Spain, France, Luxembourg
Portugal**

Ebo Systems
4, allée du Carré
Parc des Barbanniers
F - 92230 Gennevilliers
Tel. +33 (0)1 40 85 44 86
Fax. +33 (0)1 40 85 44 79
e-mail : info.fr@ebo-systems.com

Germany

Ebo Systems GmbH
Zum Gunterstal
D - 66440 Blieskastel
Tel. +49 (0)6842 - 945 6302
Fax +49 (0)6842 - 945 5284
e-mail : info.de@ebo-systems.com

Italy

Ebo Systems S.r.l.
Via Guido Rossa 5 / 7
I - 24035 Curno (BG)
Tel. +39 (0)35 46 20 88
Fax +39 (0)35 46 20 89
e-mail : info.it@ebo-systems.com

Switzerland, Austria, Eastern Europe

Ebo Systems SA
Postfach
Tambourstrasse 8
CH - 8833 Samstagern
Tel. +41 (0)1 787 87 87
Fax +41 (0)1 787 87 99
e-mail : info.ch@ebo-systems.com

**English-speaking Europe, Asia,
Middle East, Africa, America,
Australia**

Ebo Systems
Boulevard d'Europe
B.P. 10
F - 67211 Obernai Cedex
Tel. +33 (0)3 88 49 50 51
Fax. +33 (0)3 88 49 50 14
e-mail : info@ebo-systems.com